

CHIC HAYES VALLEY VIEW CONDOMINIUM

SPECTACULAR ROOFTOP VIEW TERRACE



THE HAYES | 55 PAGE STREET #724 | OFFERED AT \$899,000

This sophisticated condominium in sought after Hayes Valley combines style, character, and great curb appeal. A generous open floor plan boasting the formal living, dining area and the chef's kitchen invites entertaining on any scale. The home's personal attributes include one bedroom, one full spa bathroom, office/den/guest quarters, in-unit laundry area, ample storage, plus garage parking for one vehicle.

Situated in a trendy Hayes Valley location, this home has a walk score of 97 making it a "walker's paradise" a transit score of 100 – a "rider's paradise" -world-class transportation. "Biker's paradise" excellent at 99. The best of City living is close at hand with top-rated restaurants, neighborhood cafes, boutique shopping, and thriving entertainment - San Francisco Ballet, Opera, and Symphony, SF Jazz Center within blocks.

- 1 bedroom and 1 bathroom with office/den/guest quarters
- Elegant and spacious living room and dining area with Mechoshades window treatments
- Private balcony with expansive Southeast views
- Beautifully updated hardwood floors - Mission Collection, Palomar Serra series distressed sculpted hardwood floors - 8" plank
- Chef's kitchen has abundant custom cabinetry topped with Carrara marble counters, Carrara marble large slab breakfast bar, quality stainless steel appliances, including Studio Becker cabinetry, Liebherr refrigerator, and Hansgrohe fixtures
- Spacious master bedroom bedroom with stunning City views, custom window treatment, ample closet space by California Closet
- Full spa bath boasts Carrara marble tile counters and a custom glass shower enclosure
- In-unit (closet) Axxis Bosch Washer Dryer
- Underground garage parking - one assigned space
- Common rooftop terrace with sweeping panoramic views across the City and Bay - great for parties (BBQ) or relaxation
- Residents-only gym, full-time lobby attendant
- Monthly HOA fee of \$483.81

This material is based upon information which we consider reliable, but it has been supplied by third parties. We cannot represent that it is accurate or complete, and it should not be relied upon as such. Operated by Sotheby's International Realty, Inc. Sotheby's International Realty does not guarantee the accuracy of square footage or other information.

Sotheby's
INTERNATIONAL REALTY

San Francisco Brokerage | sothebyshomes.com/sanfrancisco
Jeffrey G. Gibson, Managing Broker
117 Greenwich Street, San Francisco, CA 94111
T 415.901.1700 | F 415.901.1707

WWW.55PAGE.COM

Linda S Gordon
415.602.1471 | CalBRE #01207031
www.LindaGordon.com
Sold@Linda-Gordon.com



55 PAGE STREET | UNIT 724

SAN FRANCISCO, CA 94102



FLOOR PLAN

Estimated Total Square Footage: 920 SQ FT

Calculated from outside face of exterior walls and center line of demising walls.

Sotheby's
INTERNATIONAL REALTY

Rendering by Floor Plan Visuals.
All measurements are approximate. While deemed reliable, no information on these floor plans should be relied upon without independent verification.

Presented by Linda Gordon, Sotheby's International Realty
Tel: 415.602.1471 | Email: sold@linda-gordon.com
www.lindagordon.com

55 PAGE STREET | UNIT 724

SAN FRANCISCO, CA 94102

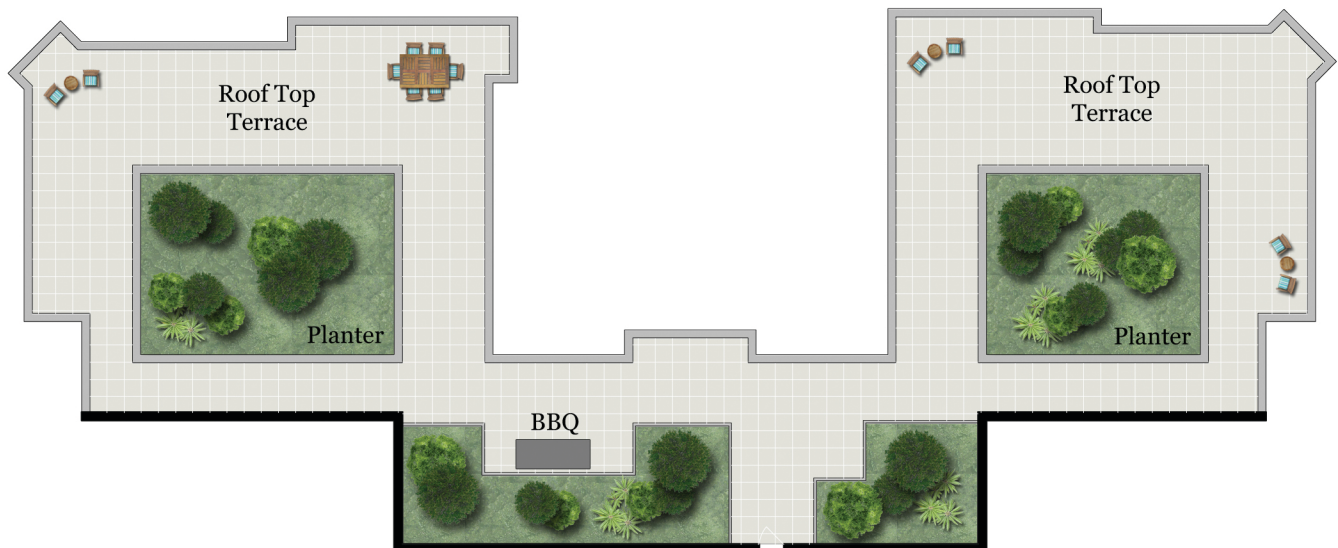

ROOF PLAN

Common Space (NTS)

Sotheby's
INTERNATIONAL REALTY

Rendering by Floor Plan Visuals.
All measurements are approximate. While deemed reliable, no information
on these floor plans should be relied upon without independent verification.

Presented by Linda Gordon, Sotheby's International Realty
Tel: 415.602.1471 | Email: sold@linda-gordon.com
www.lindagordon.com